

# **PARTS CATALOG**

**FOR A**

**J.H. FLETCHER & CO.**

**MINING PRODUCT**

CUSTOMER.....

MACHINE MODEL..... DDD-13, C-D MODERNIZATION

SERIAL NUMBER.....89307 / 84030

CUSTOMER ORDER NUMBER.....

ELECTRICAL APPROVAL NUMBER..... 2G-2751A-14

HEALTH APPROVAL NUMBER.....

PENNSYLVANIA APPROVAL NUMBER... N/A



Engineers  
Surveyors  
Planners

RALEIGH COUNTY,  
WEST VIRGINIA

## ATRS STRUCTURAL CERTIFICATE

**ESI Inc., Job Number 2575-1E**

I, Ronald Tim Thompson, P.E., do hereby certify that equipment drawings 2575-1E & 2575-2E, dated November 15, 2005, by ESI Inc., for Phillips Machine Services, Inc., entitled "ATRS Certification for Fletcher Roof Bolter DDO", and more specifically for Serial #89307/84030, Model # DDO, identified as Exhibit A, will elastically support a live load of 42,750 pounds and is in accordance with AISC specifications and as set forth in Federal Register, Part II, Department of Labor, MSHA, 30CFR Part 75, Section 75.209, E1 and E2, Rules and Regulations governing use of Automatic Temporary Roof Support Systems. Any alteration to the design or drawings VOIDS this certification.

This the 15th day of November 2005

Signed

A handwritten signature in black ink, appearing to read 'Ronald Tim Thompson', written over a horizontal line.

Ronald Tim Thompson, PE  
WV Certification #15533



ESI, Inc.

119 Appalachian Drive – Beckley, WV 25801 – (304) 255-5296 – Fax (304) 252-6077  
P. O. Box 383 – Pearisburg, VA 24134 – (540) 921-3988 – Fax (540) 921-3997



Engineers  
Surveyors  
Planners

---

RALEIGH COUNTY,  
WEST VIRGINIA

## CANOPY CERTIFICATE

**ESI Inc., Job Number 2575-3E**

I, Ronald Tim Thompson, do hereby certify that the equipment drawing 2575-E3, dated November 8, 2005, by ESI Inc., for Phillips Machine Service, entitled "Tram Canopy for Fletcher DDO" and more specifically for Serial #89307/84030, Model # DDO - 13, and further identified as Exhibit A, attached hereto, has been found to meet Federal Register, Part II, Department of Labor, MSHA, 30CFR, Part 75, Section 75.1710 and will support a uniformly distributed load equal to the lesser of 9 ton or 15 psi, the members were sized per AISC specifications. Any alteration to the design or drawings VOIDS this certification.

This the 8th day of November 2005

Signed   
Ronald Tim Thompson, P.E.  
WV Certification #15533





Engineers  
Surveyors  
Planners

RALEIGH COUNTY,  
WEST VIRGINIA

## CANOPY CERTIFICATE

**ESI Inc., Job Number 2575-4E**

I, Ronald Tim Thompson, do hereby certify that the equipment drawing 2575-E4, dated November 15, 2005, by ESI Inc., for Phillips Machine Service, entitled "Drill Canopy for Fletcher DDO" and more specifically for Serial #89307/84030, Model # DDO - 13, and further identified as Exhibit A, attached hereto, has been found to meet Federal Register, Part II, Department of Labor, MSHA, 30CFR, Part 75, Section 75.1710 and will support a uniformly distributed load equal to the lesser of 9 ton or 15 psi, the members were sized per AISC specifications. Any alteration to the design or drawings VOIDS this certification.

This the 15th day of November 2005

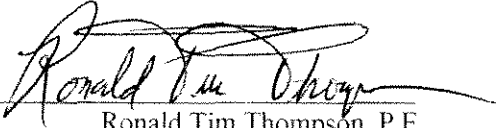
Signed   
Ronald Tim Thompson, P.E.  
WV Certification #15533



# WARNING

## READ BEFORE STARTING MACHINE

The safe operation of this machine requires special knowledge, training and experience - do not attempt to operate unless you have read the Operator's Manual and have received the task training required by MSHA (30 CFR 48.7).

- Review the SAFETY REMINDERS before starting operation.
- Perform the START OF SHIFT SAFETY CHECKLIST before placing machine in operation.
- Report any unsafe or hazardous condition to your supervisor immediately - BEFORE CONTINUING OPERATION.
- Changes in machine adjustments are to be made only by properly trained and authorized personnel.
- Do not modify machine or utilize repaired or replacement parts that do not meet J. H. Fletcher & Co. specifications.
- Always remove and lock out power at distribution box before performing inspection, maintenance or repair.
- Before leaving the section, perform the END OF SHIFT SHUTDOWN CHECKLIST.

Failure to observe the warnings above or careless operation can result in serious injury or death to yourself or others.

**THE SAFE OPERATION OF THIS MACHINE IS YOUR RESPONSIBILITY**

This and all other safety notices must be maintained on the machine at all times - DO NOT REMOVE THIS NOTICE - replace as required.

Part No. 159539



**J. H. FLETCHER & CO.**  
HUNTINGTON, W. VA.  
707 WEST 7TH STREET

R

DATE

TITLE

159539 WARNING STICKER

SHEET NO.

115-1

# **WARNING**

**PINCH POINTS CAN CAUSE  
INJURY.**

**DO NOT OPERATE WITHOUT  
GUARD IN PLACE.**

**DO NOT REMOVE LABEL.**

© J. H. Fletcher & Co., 1967

Part No. 159546

SHEET NO. WS-2	TITLE 159546 WARNING STICKER	DATE	R	<b>J. H. FLETCHER &amp; CO.</b> 707 WEST 7TH STREET HUNTINGTON W. VA
-------------------	---------------------------------	------	---	---

**DANGER**

**NEVER STAND OR  
TRAVEL BEYOND  
SUPPORTED ROOF**

**DO NOT REMOVE LABEL**

© J. H. Fletcher & Co., 1987

Part No.: 159549



SHEET NO.

WS-3

TITLE

159549 WARNING STICKER

DATE

R

**J. H. FLETCHER & CO.**

707 WEST 7TH STREET

HUNTINGTON, W. VA

**DANGER**



NEVER TOUCH OR HOLD ONTO A ROTATING DRILL STEEL WRENCH OR BOLTS.  
ALWAYS USE "HANDS OFF" DRILLING METHODS. ACCIDENTS INVOLVING  
DRILLHEAD ROTATION CAN CAUSE SERIOUS INJURY OR DEATH.

 **DO NOT REMOVE LABEL** Part. No 159543

SHEET NO. 145-4	TITLE 159543 WARNING STICKER	DATE	R	<b>J. H. FLETCHER &amp; CO.</b> 707 WEST 7TH STREET HUNTINGTON, W. VA
--------------------	---------------------------------	------	---	--



(Fill in Chemical Name)

HEALTH  
HAZARD

FIRE  
HAZARD

REACTIVITY

Consult Corresponding  
MSDS for Further  
Hazardous Information  
and Instructions

4 Severe  
3 Serious  
2 Moderate  
1 Slight  
0 Minimal

AH Acid  
AK Alkal  
CB Corrosive  
OX Oxidizer  
P Polymerization  
R Reacting  
with water  
T Toxic  
W Water Reactive  
X Irritant  
Y Harmful

SPECIFIC  
HAZARD

**Personal Protection**  
(✓ Mark Appropriate Protection Required)

<input type="checkbox"/> Safety Glasses	<input type="checkbox"/> Apron	<input type="checkbox"/> Respirator
<input type="checkbox"/> Face Shield	<input type="checkbox"/> Boots	<input type="checkbox"/> Self Contained Air Respirator
<input type="checkbox"/> Gloves	<input type="checkbox"/> Splash Goggles	<input type="checkbox"/> Full Protection Suit
<input type="checkbox"/> OTHER	<input type="checkbox"/> OTHER	<input type="checkbox"/> OTHER

SHEET NO.

WS-5

TITLE

159578 WARNING STICKER

DATE

R

**J. H. FLETCHER & CO.**

707 WEST 7TH STREET HUNTINGTON, W. VA.

# WARNING



NEVER OPERATE ANY CONTROL IN THE TRAM DECK  
UNLESS SEATED INSIDE THE TRAM DECK WITH YOUR  
**ENTIRE BODY INSIDE.**



**DO NOT REMOVE LABEL** Part No 159542

SHEET NO.

WS--6

TITLE

159542 WARNING STICKER

DATE

R

**J. H. FLETCHER & CO.**

707 WEST 7TH STREET

HUNTINGTON, W VA

**DANGER**

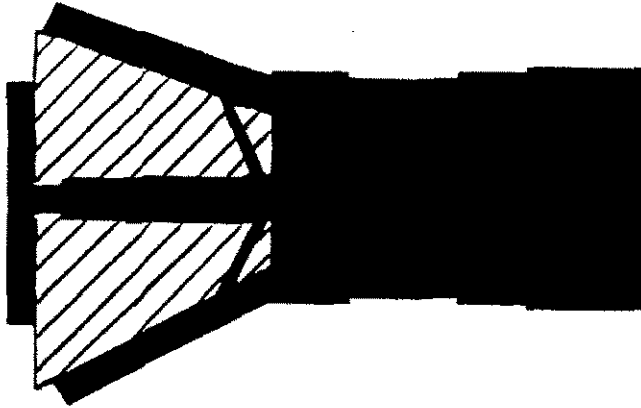

**NEVER ENTER** AREA IN RED UNLESS POWER TO THE MACHINE HAS BEEN DISCONNECTED & LOCKED OUT.



**DO NOT REMOVE LABEL**

Part No. 158541



INDICATES RED AREA ON STICKER

**J. H. FLETCHER & CO.**  
707 WEST 7TH STREET  
HUNTINGTON, W. VA.

R

DATE

TITLE

159541 WARNING STICKER

SHEET NO.

115-8

# WARNING

**Before Performing Maintenance, Repair  
Or Inspection In This Area Fully Lower or  
Securely Block All Moving Parts and  
Disconnect And Lock Out Power.**

**Serious Injury Can Occur From  
Fallure To Observe This Warning.**

**DO NOT REMOVE LABEL**

© J. H. Fletcher & Co., 1967

Part No. 159538

SHEET NO.	TITLE	DATE	R	<b>J. H. FLETCHER &amp; CO.</b>	
WS-10	159538 WARNING STICKER			707 WEST 7TH STREET	HUNTINGTON, W VA

**DANGER**  
**! PINCH !**  
**! POINT !**  
**AREA**  
**KEEP**  
**CLEAR**  
DO NOT REMOVE LABEL.  
© J. H. Fletcher & Co., 1967  
Part No. 159545

SHEET NO.  
WS-11

TITLE  
159545 WARNING STICKER

DATE

R

**J. H. FLETCHER & CO.**  
707 WEST 7TH STREET  
HUNTINGTON, W. VA.

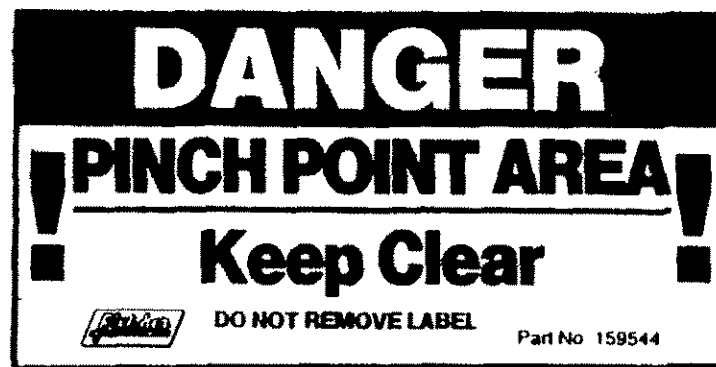

SHEET NO. WS-12	TITLE 159544 WARNING STICKER	DATE	R	<b>J. H. FLETCHER &amp; CO.</b> 707 WEST 7TH STREET HUNTINGTON, W. VA.
--------------------	---------------------------------	------	---	---



INNOVATION IN PRODUCT DESIGN

SERVICE MACHINE CO.  
9872 OHIO RIVER RD. HUNTINGTON, WV 25782  
P.O. BOX 8177 HUNTINGTON, WV 25786  
PHONE 384/736-8833 TWX 718 931 1929

**NOTICE TO COAL MINE OPERATORS AND MAINTENANCE PERSONNEL**

This ELECTRICAL EQUIPMENT is APPROVED or CERTIFIED by MSHA in accordance with 30 CFR 18, and is also subject to the provisions of 30 CFR 75 where applicable.

Installation and Maintenance to be carried out by authorized personnel.

Equipment to be frequently examined, tested and properly maintained in safe and permissible condition.

Maintain the equipment in conformity with SERVICE MACHINE CO's. MSHA APPROVED drawings. Always use replacement parts identical to those supplied by SERVICE MACHINE CO. (Refer to full "CAUTION STATEMENT" for details.)

PART NO. 159524

SHEET NO.	TITLE	DATE	R	<b>J. H. FLETCHER &amp; CO.</b> 707 WEST 7TH STREET HUNTINGTON, W VA
WIS-13	159524 WARNING STICKER			

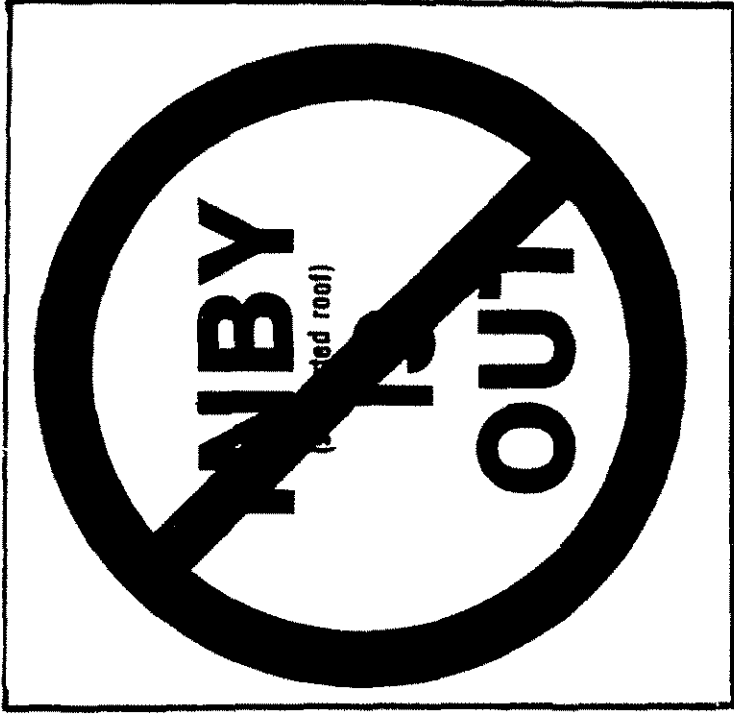

SHEET NO.

W5-18

TITLE

159610 WARNING STICKER

DATE

R

**J. H. FLETCHER & CO.**  
707 WEST 7TH STREET HUNTINGTON W. VA.



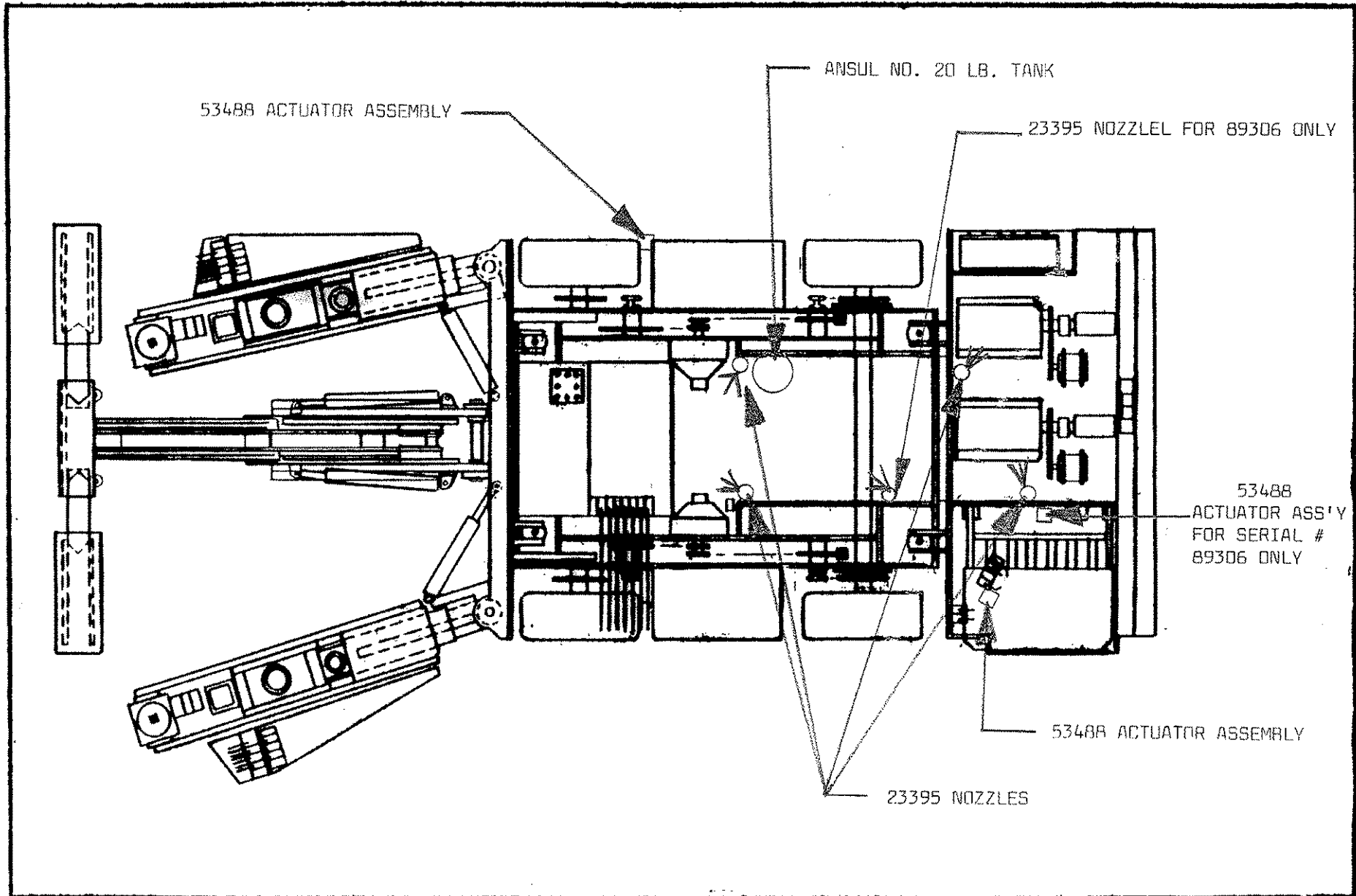

SHEET NO	TITLE	DATE	R	J. H. FLETCHER & CO.
	LOCATIONS FOR FIRE CONTROL SYSTEM			107 WEST 7TH STREET HARRINGTON, W. VA.

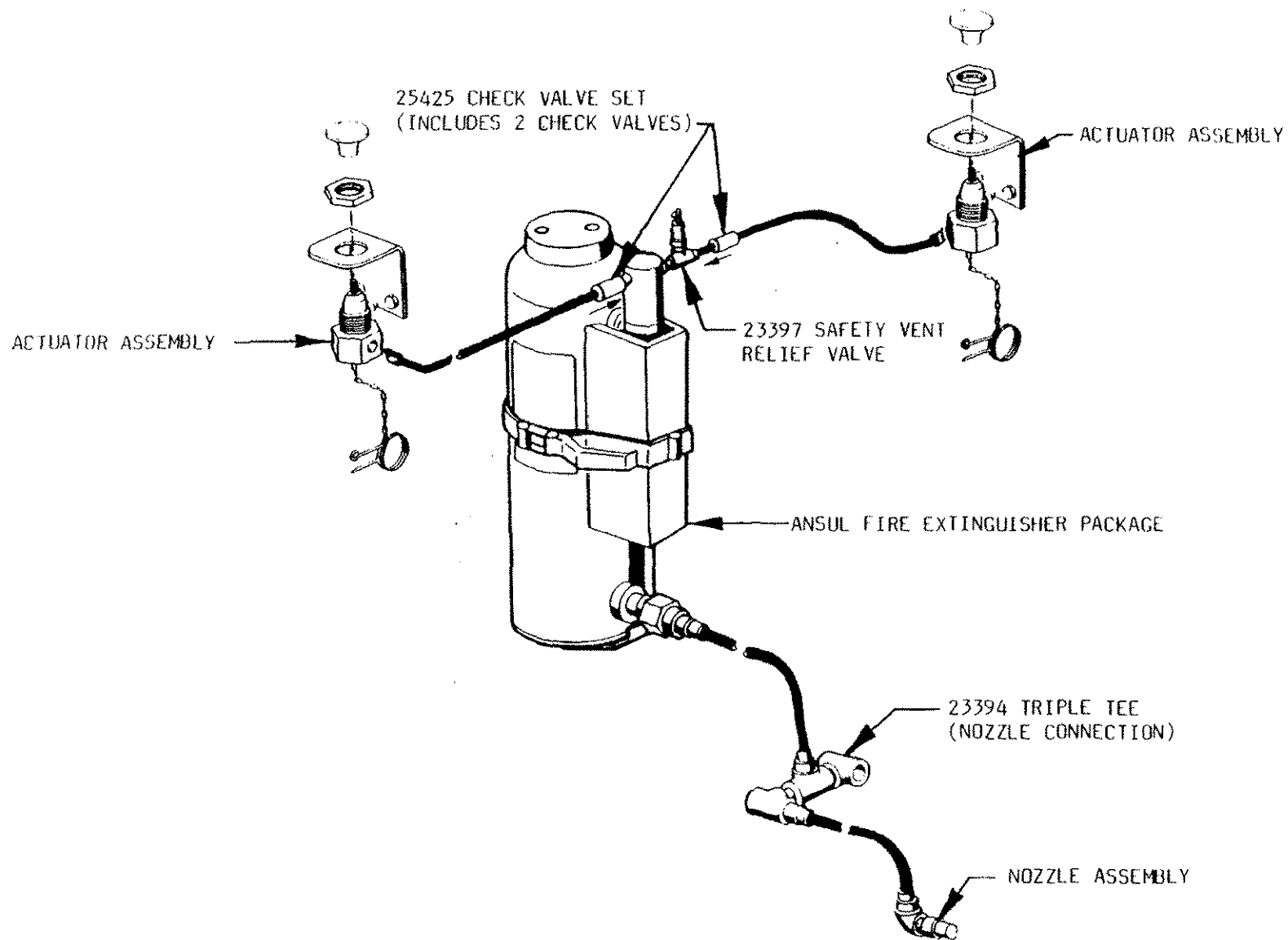

SHEET NO.	TITLE ANSUL FIRE SYSTEM ARRANGEMENT	DATE	R	<b>J. H. FLETCHER &amp; CO.</b> 707 WEST 7TH STREET HUNTINGTON, W. VA
-----------	--	------	---	--

3695

SHEET NO.	TITLE 45295 ANSUL 20LB. FIRE EXTINGUISHER PACKAGE	DATE	R	<b>J. H. FLETCHER &amp; CO.</b> 707 WEST 7TH STREET HUNTINGTON, W. VA
-----------	--	------	---	--

<u>ITEM</u>	<u>DESCRIPTION</u>	<u>PART NO.</u>
1	SHELL ASSEMBLY	25315
2	BURSTING DISC UNION ASSEMBLY	25265
3	UNION RING & TAIL PIECE	25316
4	BURSTING DISC	25264
5	ADAPTOR	25317
6	CARTRIDGE ASSEMBLY	25261
7	CARTRIDGE GUARD ASSEMBLY	25332
8	CLIP	25263
9	FORK	25333
10	RIVET	NONE
11	PNEUMATIC CARTRIDGE RECIEVER ACTUATOR	25319
12	GASKET	25260
13	ACTUATOR BODY	25320
14	"O" RING (2 REQ'D)	25321
15	PNEUMATIC SLAVE PISTON	25322
16	PUNCTURE PIN ASSEMBLY	25323
17	SPRING	25324
18	ADAPTOR	25325
19	FILL CAP ASSEMBLY	25326
20	GASKET	25327
21	GUARD RING	25328
24	BRACKET ASSEMBLY	25330

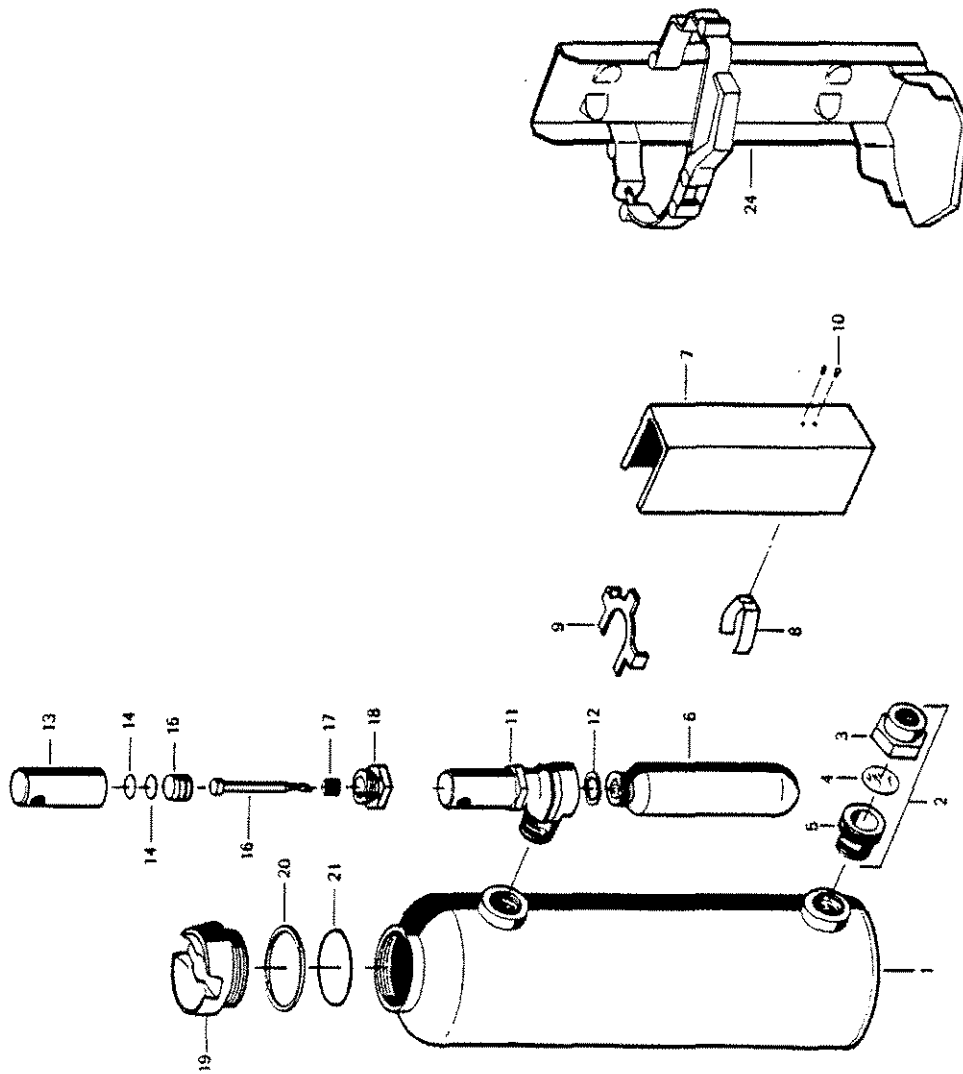

SHEET NO.

TITLE  
 45295 ANSUL 20LB. FIRE EXTINGUISHER PACKAGE

DATE

R

J. H. FLETCHER & CO.  
 707 WEST 7TH STREET  
 HUNTINGTON, W. VA.

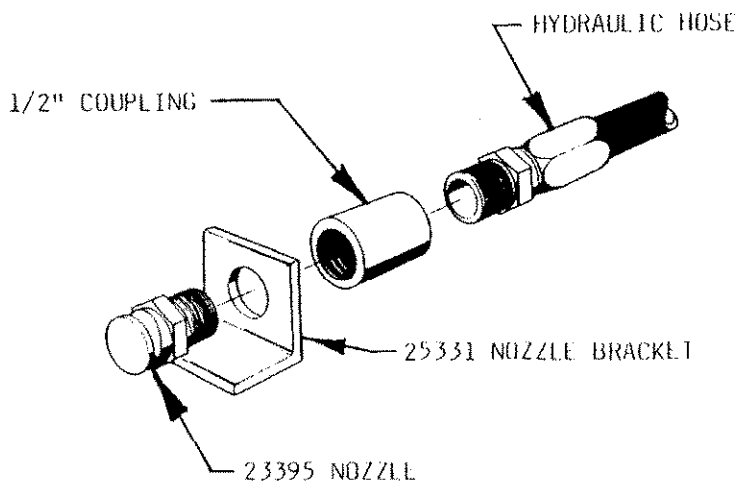

NOZZLE ARRANGEMENT

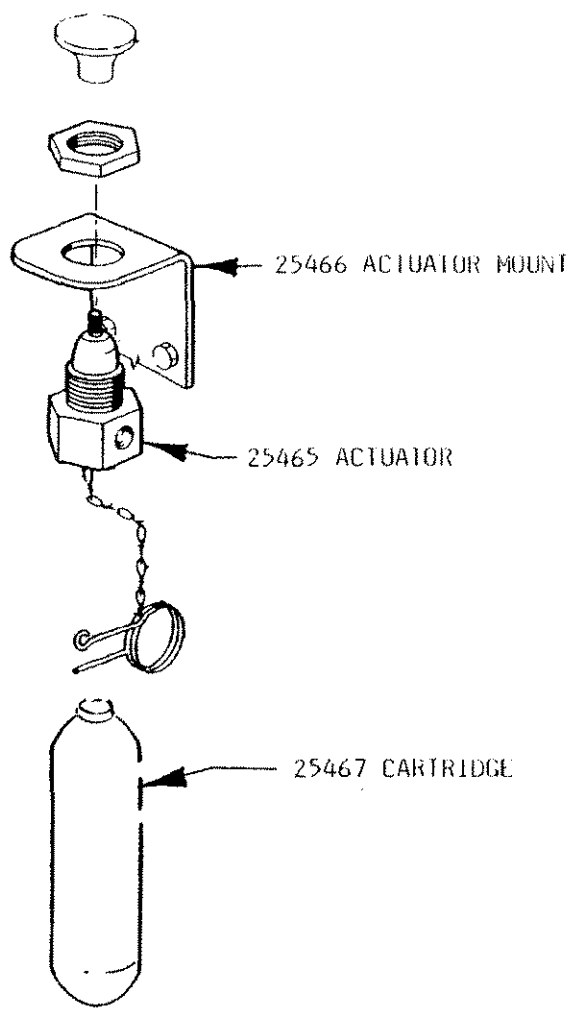

53488 ACTUATOR ASSEMBLY

39806

SHEET NO.	TITLE ANSUL FIRE SYSTEM INFORMATION	DATE	R	<b>J. H. FLETCHER &amp; CO.</b> 707 WEST 7TH STREET HUNTINGTON, W. VA
-----------	--	------	---	--



### INSPECTION — PNEUMATIC ACTUATION

To provide reasonable assurance that your Ansel A-101 System is charged and operable:

1. Make certain extinguisher is in its designated place.
2. Note general appearance for mechanical damage or corrosion.
3. Check nameplate(s) for readability.
4. Remove fill cap assembly.
5. Make certain extinguisher is filled with free-flowing Ansel dry chemical to a level of not more than 3 inches from the bottom of the fill opening.
6. Secure fill cap, hand tighten.
7. Remove cartridge from extinguisher and examine disc — seal should be unruptured.
8. Return cartridge to cartridge receiver/actuator assembly, hand tighten.
9. Check piping (hose), fittings and nozzles for mechanical damage and cuts.
10. Check nozzle openings — slot should be closed (capped) with silicone grease or covered with black plastic blow-off cap (Part No. 4120).
11. Remove cartridge from remote actuator, and examine disc — seal should be unruptured.
12. Return cartridge to remote actuator assembly, hand tighten.
13. Replace any broken or missing lead and wire seals and record date of inspection.

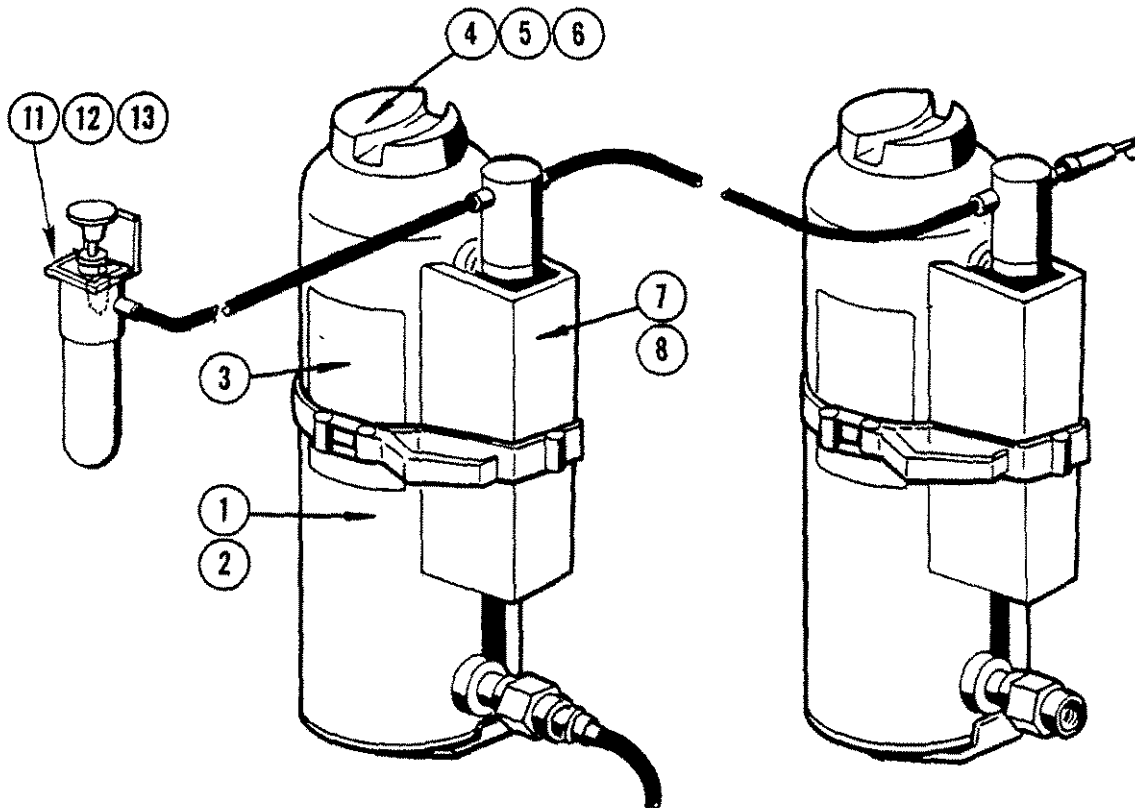

Numbers are keyed to instructions.

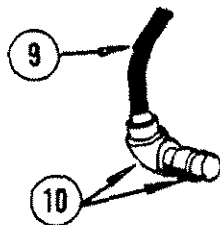



### INSPECTION – AUTOMATIC/MECHANICAL ACTUATION

To provide reasonable assurance that your Ansuil A-101 system is fully charged and operable:

1. Make certain extinguisher is in designated place.
2. Note general appearance for mechanical damage.
3. Check nameplate for readability.
4. Check visual seal on ring pin in cocking handle.
5. Check visual release indicator position – should be in "cocked" position.
6. Check piping, fittings, blow-off caps and nozzles for mechanical damage.
7. Check nozzle openings – slot should be closed (capped) with silicone grease or covered with black plastic blow-off cap (Part No. 4120).
8. Record date of inspection.

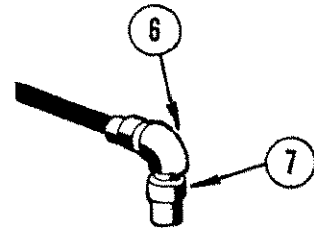
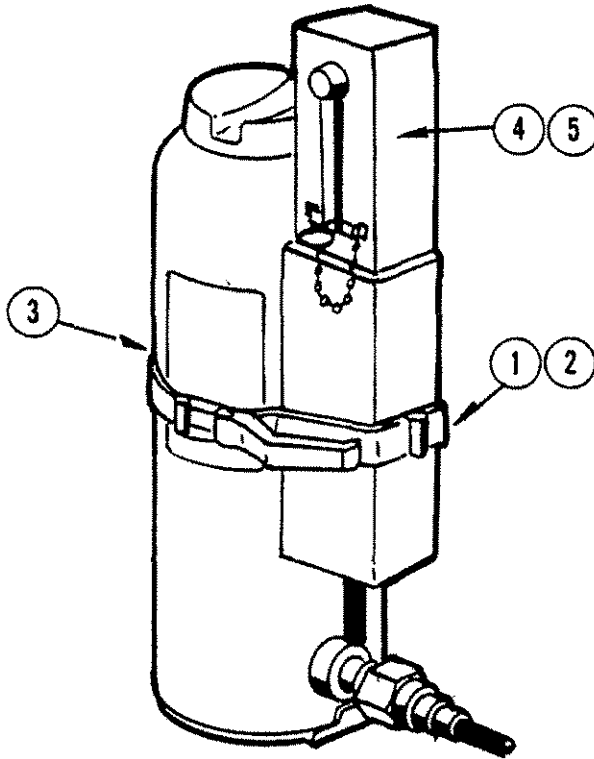

Numbers are keyed to instructions.



## MAINTENANCE – AUTOMATIC/MECHANICAL ACTUATION

To provide reasonable assurance that your Ansul A-101 System will operate effectively and safely:

1. Make certain extinguisher is in designated place.
2. Note general appearance for mechanical damage.
3. Check nameplate for readability.
4. Install ring pin in actuator/cartridge receiver.
5. Remove cover plate from extinguisher side of release.
6. Disconnect bursting disc union.
7. Release holding strap and remove extinguisher.
8. Check the bursting disc to insure that it has not been ruptured and is properly installed – full disc side must face extinguisher.
9. Remove fill cap.
10. Check threads on fill cap and in fill opening for nicks, burrs, cross threading, rough or feathered edges.
11. Check pressure relief vent hole in fill opening for obstructions.
12. Check fill cap gasket for elasticity – clean and coat lightly with good grade of high heat resistant grease.
13. Make certain tank is filled with free-flowing Ansul dry chemical to a level not more than 3 inches from bottom of fill opening.
14. Secure fill cap, hand tighten.
15. Remove cartridge guard assembly.
16. Remove cartridge and weigh. Weight must be within ¼ ounce of weight stamped on cartridge.
17. Screw in cartridge, hand tighten.
18. Replace cartridge guard.  
(DO NOT REINSTALL EXTINGUISHER AT THIS TIME.)
19. Check hose, fittings, and nozzles for mechanical damage.
20. Check nozzle openings – slot should be closed (capped) with silicone grease or covered with black plastic blow-off cap (Part No. 4120).
21. Install fusible link in detector(s).
22. Cut or melt fusible link to test fire detection system.

NOTE: If system does not fire, check wire rope tension – adjust tension on wire rope and cock the release. Repeat Steps 21 and 22.

23. After successful test firing, cock release and secure with ring pin and seal with visual seal (Part No. 15999).
24. Reinstall fully charged extinguisher.  
Reassemble bursting disc union, wrench tighten.  
Secure extinguisher with holding strap.
25. Replace cover on mechanical release.
26. Remove ring pin from actuator/cartridge receiver.
27. Record date of maintenance.

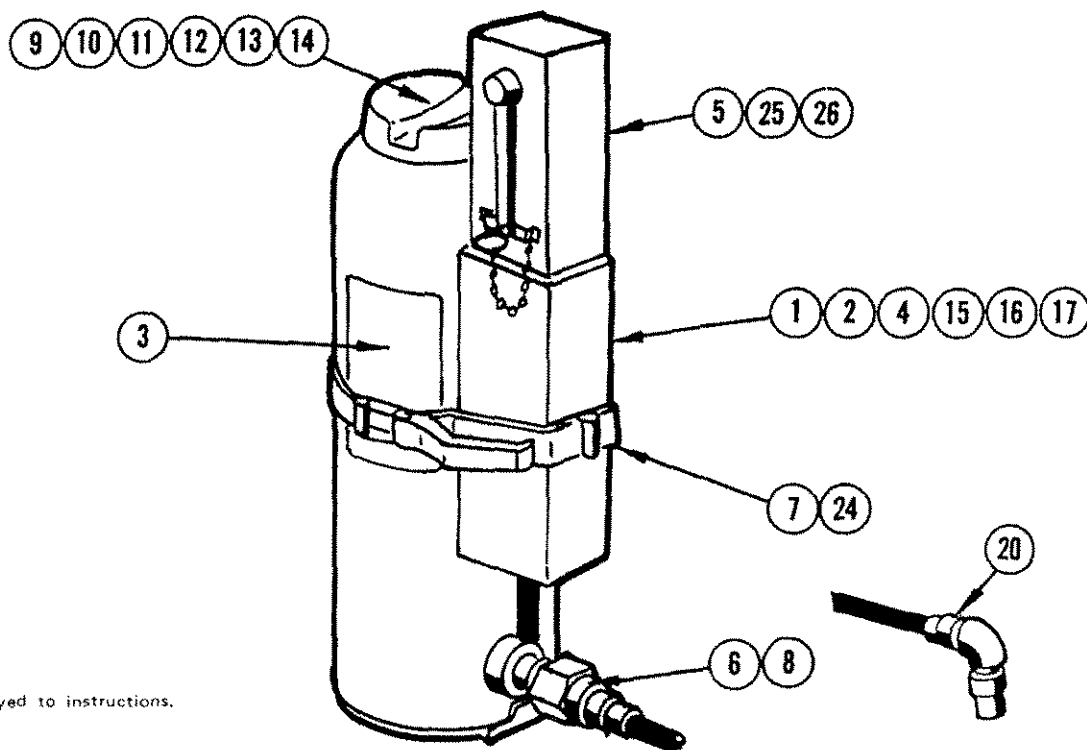

Numbers are keyed to instructions.





## MAINTENANCE – PNEUMATIC ACTUATION

To provide maximum assurance that your Ansil A-101 System will operate effectively and safely:

1. Note general appearance for mechanical damage or corrosion.
2. Check nameplate for readability, corrosion or looseness.
3. Remove fill cap assembly.
4. Examine fill cap gaskets for elasticity – clean and coat lightly with a good grade of high heat resistant grease.
5. Inspect threads on fill cap and in fill opening for nicks, burrs, cross threading, rough or feathered edges.
6. Check pressure relief vent in fill opening threads for obstruction.
7. Make certain extinguisher is filled with free-flowing Ansil FORAY dry chemical to a level of not more than 3 inches from bottom of fill opening.
8. Secure fill cap, hand tighten.
9. Remove extinguisher cartridge guard assembly.
10. Unscrew cartridge and weigh (replace if weight is 1/4 oz. less than stamped on cartridge).
11. Inspect threads on cartridge and in receiver/actuator for nicks, burrs, cross threading, rough or feathered edges.
12. Check pressure vents in receiver/actuator for obstruction.
13. Examine cartridge receiver gasket for elasticity – clean and coat lightly with a good grade of high heat resistant grease. Return cartridge to receiver/actuator, hand tighten.

14. Disengage bursting disc union and open bracket clamp.
15. Lift extinguisher partially out of bracket and examine bursting disc – should be installed with full disc side facing extinguisher, properly seated and undamaged (scored, or ruptured).
16. Reposition extinguisher, engage bursting disc union (wrench tighten) and close bracket clamp.
17. Check hose, fittings and nozzles for mechanical damage.
18. Check nozzle openings – slot should be closed (capped) with silicone grease or covered with black plastic blow-off cap (Part No. 4120).
19. Check remote actuator – **DASHBOARD TYPE.**  
Remove cartridge and weigh (replace if weight is 1/4 oz. less than stamped on cartridge).  
Inspect threads on cartridge and in actuator for nicks, burrs, cross threading, rough or feathered edges.  
Check pressure safety vent in actuator body for obstruction.  
Examine actuator cartridge gasket for elasticity – clean and coat lightly with a good grade of high heat resistant grease.  
Pull ring pin and operate actuator button several time to check for free movement.
20. Seal ring pin to puncture lever with lead and wire seal, Ansil Part No. 197. Return cartridge to remote actuator, hand tighten.
21. Notify operating personnel extinguishing system is back in service and record date of maintenance check.

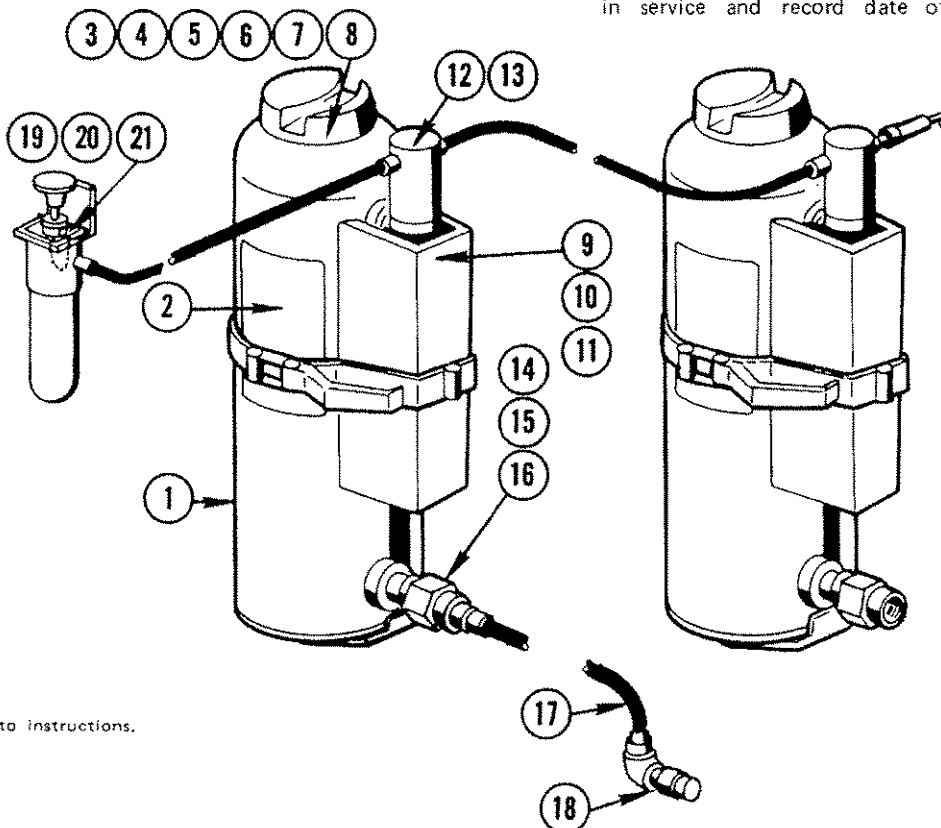

Numbers are keyed to instructions.

TEE

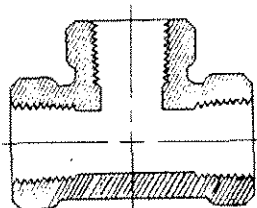
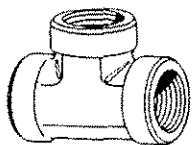

<u>PART NO.</u>	<u>THREAD SIZE</u>
20427	1/4"
20428	3/8"
20429	1/2"
20430	3/4"
20481	1"

90° ELBOW

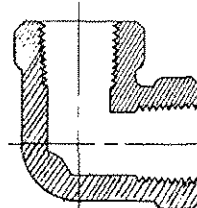
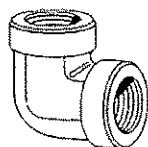

<u>PART NO.</u>	<u>THREAD SIZE</u>
20417	1/4"
20418	3/8"
20419	1/2"
20420	3/4"
20421	1"
20422	1-1/4"

45° ELBOW

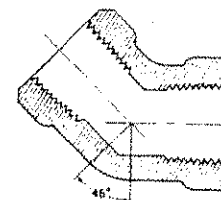
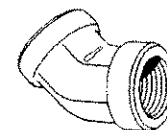

<u>PART NO.</u>	<u>THREAD SIZE</u>
20432	1/4"
20433	3/8"
32813	1/2"
32814	3/4"
32815	1"
32816	1-1/4"

SHEET NO.

N.P.T.

TITLE

STANDARD PIPE FITTINGS

DATE

R

**J. W. FLETCHER & CO.**

707 WEST 7TH STREET

HUNTINGTON, W. VA.

**MALE RUN TEE**

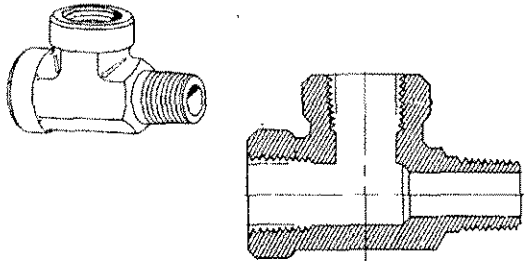

<u>PART NO.</u>	<u>THREAD SIZE</u>
20423	1/4"
20424	3/8"
20425	1/2"
20426	3/4"
20301	1"

**90° STREET ELBOW**

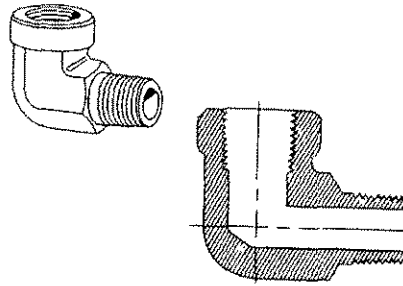

<u>PART NO.</u>	<u>THREAD SIZE</u>
32809	1/4"
32810	3/8"
32811	1/2"
20257	3/4"
32812	1"
20412	1-1/4"

**45° STREET ELBOW**

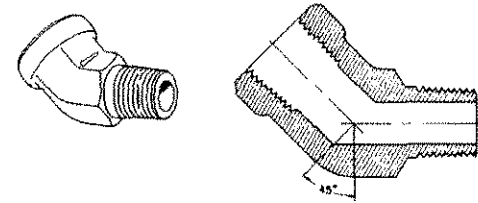

<u>PART NO.</u>	<u>THREAD SIZE</u>
20414	1/4"
20415	3/8"
20416	1/2"
32735	3/4"
20250	1"

SHEET NO.

N.P.T.

TITLE

STANDARD PIPE FITTINGS

DATE

R

**J. W. FLETCHER & CO.**

707 WEST 7TH STREET

HUNTINGTON, W. VA.

# BUSHING

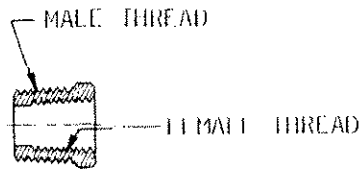

<u>PART NO.</u>	<u>MALE THREAD</u>	<u>FEMALE THREAD</u>
32445	1"	3/4"
32446	1"	1/2"
32447	1"	3/8"
32448	1"	1/4"
32449	3/4"	1/2"
32450	3/4"	3/8"
32451	3/4"	1/4"
32452	1/2"	3/8"
32453	1/2"	1/4"
32454	3/8"	1/4"
32822	1/4"	1/8"

<u>PART NO.</u>	<u>MALE THREAD</u>	<u>FEMALE THREAD</u>
32663	2-1/2"	2"
32436	2-1/2"	1-1/2"
32817	2-1/2"	1-1/4"
32818	2"	1-1/2"
32819	2"	1-1/4"
32437	1-1/2"	1-1/4"
32438	1-1/2"	1"
32820	1-1/2"	3/4"
32439	1-1/2"	3/8"
32440	1-1/4"	1"
32441	1-1/4"	3/4"
32442	1-1/4"	1/2"
32443	1-1/4"	3/8"
32444	1-1/4"	1/4"

SHEET NO. N.P.T.	TITLE STANDARD PIPE FITTINGS	DATE	R	<b>J. H. FLETCHER &amp; CO.</b> 707 WEST 7TH STREET HUNTINGTON, W. VA.
---------------------	---------------------------------	------	---	--

**MALE PIPE TO MALE J.I.C.**



(STRAIGHT MALE ADAPTOR)

<u>PART NO.</u>	<u>SIZE</u>
20570	1" PIPE TO 1" JIC
20571	1/2" PIPE TO 1/2" JIC
20572	3/4" PIPE TO 3/4" JIC
20573	3/8" PIPE TO 3/8" JIC
20574	1/4" PIPE TO 1/4" JIC
20577	3/4" PIPE TO 1/2" JIC
20578	3/4" PIPE TO 1" JIC
20579	1/2" PIPE TO 3/8" JIC
20580	1/2" PIPE TO 3/4" JIC
20581	1/2" PIPE TO 1" JIC
20582	3/8" PIPE TO 1/2" JIC
20583	3/8" PIPE TO 3/4" JIC
20584	1/4" PIPE TO 3/8" JIC
20585	1/4" PIPE TO 1/2" JIC

**MALE PIPE TO MALE J.I.C.**

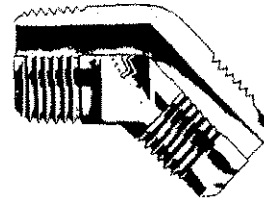

(45° MALE ELBOW)

<u>PART NO.</u>	<u>SIZE</u>
20586	1" PIPE TO 1" JIC
20587	3/4" PIPE TO 3/4" JIC
20588	1/2" PIPE TO 1/2" JIC
20589	3/8" PIPE TO 3/8" JIC
20590	1/4" PIPE TO 1/4" JIC
20591	1" PIPE TO 3/4" JIC
20592	3/4" PIPE TO 1" JIC
20593	1/2" PIPE TO 3/4" JIC
20594	1/2" PIPE TO 1" JIC
20595	3/8" PIPE TO 1/2" JIC
20596	3/8" PIPE TO 3/4" JIC
20597	1/4" PIPE TO 1/2" JIC

**MALE J.I.C. TO MALE J.I.C.**

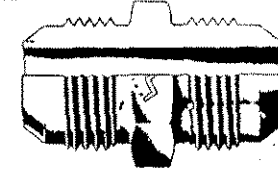

(STRAIGHT ADAPTOR UNION)

<u>PART NO.</u>	<u>SIZE</u>
20613	3/4" PIPE TO 3/4" JIC
20614	1" PIPE TO 1" JIC
20615	1/2" PIPE TO 1/2" JIC
20616	3/8" PIPE TO 3/8" JIC
20617	1/4" PIPE TO 1/4" JIC

SHEET NO.

J.I.C.

TITLE

HYDRAULIC HOSE FITTINGS

DATE

R

**J. W. FLETCHER & CO.**

707 WEST 7TH STREET

HUNTINGTON, W. VA.

MALE PIPE TO MALE J.I.C.

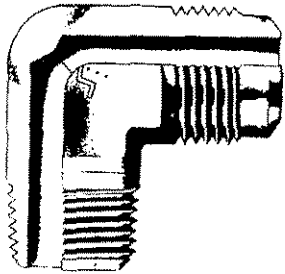

(90° MALE ELBOW)

<u>PART NO.</u>	<u>SIZE</u>
20598	1" PIPE TO 1" JIC
20599	3/4" PIPE TO 3/4" JIC
20600	1/2" PIPE TO 1/2" JIC
20601	3/8" PIPE TO 3/8" JIC
20602	1/4" PIPE TO 1/4" JIC
20603	1" PIPE TO 1-1/4" JIC
20604	3/4" PIPE TO 1/2" JIC
20605	3/4" PIPE TO 1" JIC
20606	1/2" PIPE TO 3/8" JIC
20607	1/2" PIPE TO 3/4" JIC
20608	1/2" PIPE TO 1" JIC
20609	3/8" PIPE TO 1/2" JIC
20610	3/8" PIPE TO 3/4" JIC
20611	1/4" PIPE TO 3/8" JIC
20612	1/4" PIPE TO 1/2" JIC

SHEET NO.

J. I. C.

TITLE

HYDRAULIC HOSE FITTINGS

DATE

R

**J. W. FLETCHER & CO.**

707 WEST 7TH STREET

HUNTINGTON, W. VA.

SHEET NO. L-269	TITLE LUBRICATION DIAGRAM FOR DDO W/FRONT & REAR LIFT	DATE	R	<b>J. H. FLETCHER &amp; CO.</b> 707 WEST 7TH STREET HUNTINGTON, W. VA.
--------------------	--	------	---	---

ITEM	DESCRIPTION	RECOMMENDED LUBRICATION	INTERVAL
1	DRILLHEAD FLINGER	GREASE (MULTI-PURPOSE #2 LITHIUM)	EACH SHIFT
2	DRILLHEAD PIVOT PIN	" " " " "	WEEKLY
3	DRILLHEAD OIL LEVEL	SAE 90 or 80w/90 MULTI-PURPOSE GEAR LUBE	DAILY (FLUSH BOX WEEKLY)
4	BOOM ARM PIVOT PIN	GREASE (MULTI-PURPOSE #2 LITHIUM)	WEEKLY
5	FLID CYLINDER PIVOT PIN	" " " " "	WEEKLY
6	FLID CYLINDER ANCHOR PIN	" " " " "	WEEKLY
7	BOOM ARM PIVOT PIN	" " " " "	WEEKLY
8	ROLLER PIVOT PIN	" " " " "	WEEKLY
9	FOOT PIVOT PIN	" " " " "	WEEKLY
10	ROLLER ASSEMBLY	" " " " "	WEEKLY
11	BLOWER ASSEMBLY	SEE BLOWER INSTRUCTION MANUAL	AS RECOMMENDED
12	BOOM PIVOT PIN	GREASE (MULTI-PURPOSE #2 LITHIUM)	WEEKLY
13	FRONT TILT CYD. (TOP & BOTTOM)	" " " " "	WEEKLY
14	WHEEL HUB ASSEMBLY	" " " " "	MONTHLY
15	OIL TANK	ASTM 315 or ISO-VG68 ANTI-WEAR HYDRAULIC OIL	AS NEEDED
16	FRONT COUNTERSHAFT ASS'Y	GREASE (MULTI-PURPOSE #2 LITHIUM)	MONTHLY
17	REAR COUNTERSHAFT ASS'Y	" " " " "	MONTHLY
19	DISC BRAKE CALIPER ASS'Y	" " " " "	MONTHLY
21	HYDRAULIC FILTER	CHANGE ELEMENT	RED INDICATOR
22	ELECTRIC MOTORS	SEE ELECTRIC MOTOR INSTRUCTION MANUAL	AS RECOMMENDED
23	FRONT END PIVOT	GREASE (MULTI-PURPOSE #2 LITHIUM)	MONTHLY
24	REAR TILT CYD. (TOP & BOTTOM)	" " " " "	WEEKLY
25	REAR COUNTERSHAFT ASS'Y	" " " " "	MONTHLY

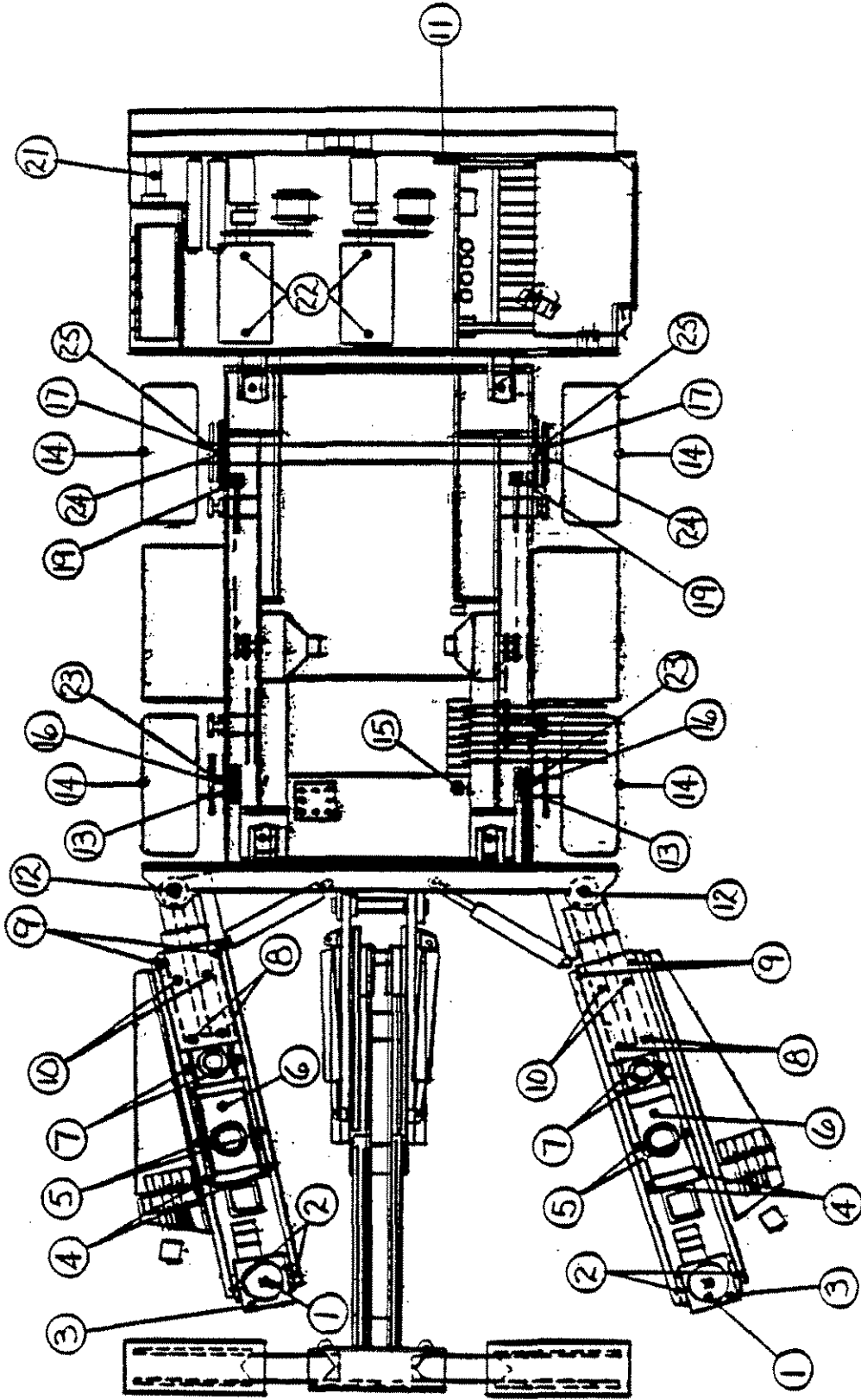

SHEET NO  
1-269

TITLE  
LUBRICATION DIAGRAM FOR DDO W/FRONT/REAR LIFT

PATE

R

J. H. FLETCHER & CO.  
121 WEST 11TH STREET  
HUNTINGTON, W. VA.



ITEM	DESCRIPTION	LUBRICATION	INTERVAL	HOURS
1	RAISE CYLINDER EYES	MULTI-PURPOSE #2 LITHIUM GREASE	WEEKLY	100 hrs.
2	FOOT CYLINDER EYES	" " " "	WEEKLY	"
3	UPPER LEMNISCATE LINK	" " " "	WEEKLY	"
4	LOWER LEMNISCATE LINK	" " " "	WEEKLY	"
5	TRS BEAM LINK PIVOT	" " " "	WEEKLY	"

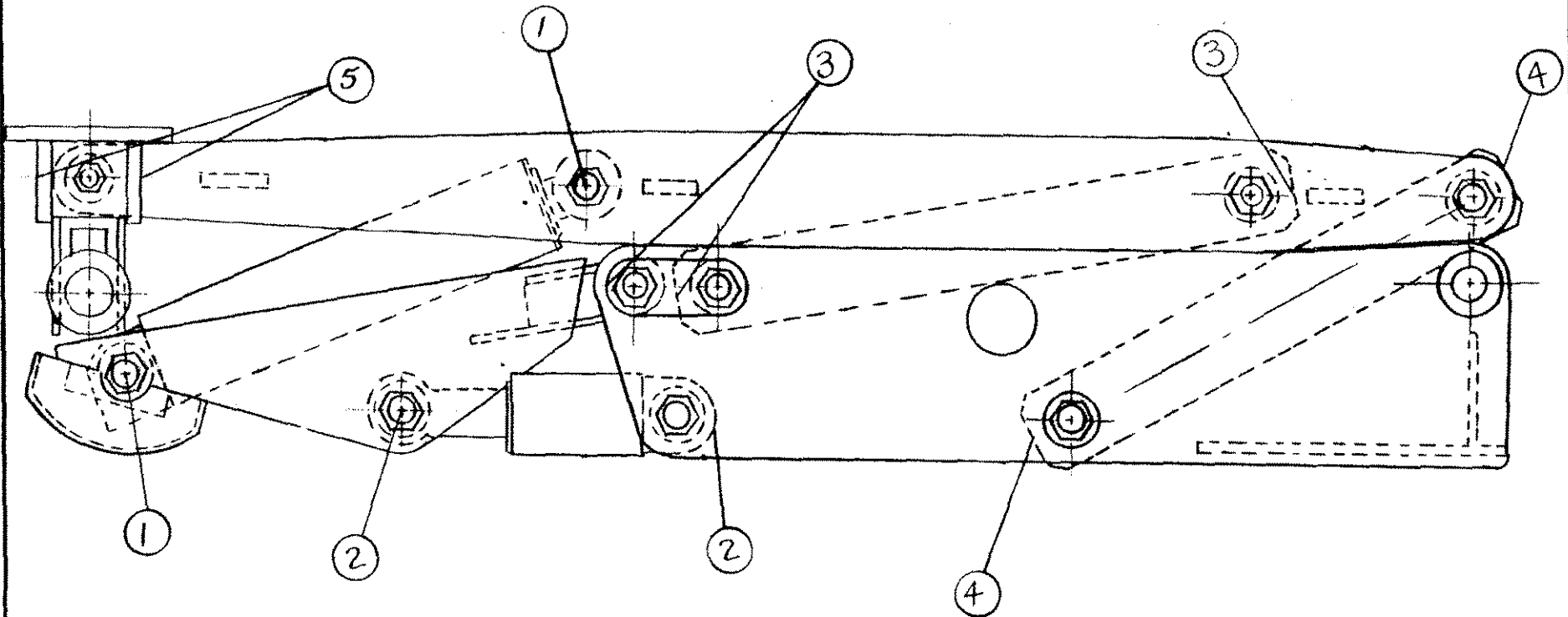

SHEET NO. L-329	TITLE L-STYLE TRS LUB DIAGRAM	DATE 10-15-86	R <b>J. H. FLETCHER &amp; CO.</b> 707 WEST 7TH STREET HUNTINGTON, W. VA.
--------------------	----------------------------------	------------------	--

## RECOMMENDED SPARE PARTS LIST

This list of recommended spare parts is sectionalized in line with your machine parts book for simple location. Parts not factory stocked will be marked with an asterisk (\*).

### MISCELLANEOUS SECTION:

NO RECOMMENDATIONS

### ELECTRICAL SECTION:

1		HEADLIGHT SWITCH
1	46600	START-START SWITCH
1	46611	START SWITCH
2	46718	1' TAPE SWITCH PANIC BAR
1	49412	I.S. RELAY ASSEMBLY

### PUMP, ELECTRIC MOTOR AND BLOWER SECTION:

1	143803	HYDRAULIC PUMP
1	40842	COUPLING
2	18289	GAUGE
2	45176	OIL FILTER ELEMENT (HAND PUMP)
1	42098	BLOWER ASSEMBLY
2	80441	BLOWER ADAPTER
4	20352	DUST HOSE INSERT (1-1/4)
1	53489	MUFFLER
1	46930	INTAKE AIR FILTER
4	43502	"V" BELTS

### TRAM SECTION:

2	40202	BEARING (COUNTERSHAFT)
1	54042 *	FRONT LIFT CYLINDER
1	44516 *	REAR INSIDE TRAM CHAIN
1	40712 *	FRONT INSIDE TRAM CHAIN
1	44747 *	REAR INSIDE TRAM CHAIN
1	34008	SPLINED COUNTERSHAFT
1	41803	TRAM DRIVE MOTOR

DRILL AND BOOM SECTION:

1	54111 *	L.H. BOOM SUMP CYLINDER
1	54111 *	R.H. BOOM SUMP CYLINDER
1	*	DRILLHEAD W/MOTOR
1	54109 *	DRILL FEED CYLINDER
1	188761	BOOM ROLLER ASSEMBLY
1	54603 *	BOOM SWING CYLINDER
1	54110 *	RETRACTING FOOT CYLINDER

DUST COLLECTION:

4	46861	FILTER ELEMENT
4	51436	RUBBER LATCH

SAFETY SECTION:

2	152001*	DRILL CANOPY RAISE CYLINDER
2	56719 *	TRS FOOT CYLINDER
1	54992 *	TRS RAISE CYLINDER
2	56663 *	BEAM CYLINDER

VALVE SECTION:

1	47447	DUAL DIVERSION VALVE
1	31530 *	SHUTTLE VALVE
1	36971	MOTION CONTROL VALVE
1	33787	TRS VALVE PACKAGE (RAISE)
2	31468	FLOW CONTROL VALVE
1	31538	DRILLFEED VALVE
1	36751	TORQUE/THRUST RELIEF VALVE
1	31569	DIRECTIONAL CONTROL VALVE
1	31508	FLOW CONTROL VALVE
1	45414	HYDRAULIC ACCUMULATOR
1	2531	CHECK VALVE
1	31658	RELIEF VALVE
1	38139	FAST FEED VALVE

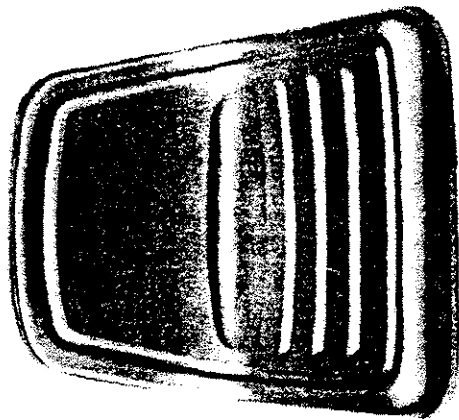

SHEET NO.,

MX-40

TITLE

3210 OPERATORS SEAT

DATE

10-16-85

R

J. H. FLETCHER & CO.

707 WEST 7TH STREET  
HUNTINGTON, W. VA.